

# POWERED FLEX CONVEYOR WORKSHEET

Company \_\_\_\_\_ Date \_\_\_\_\_  
 Contact \_\_\_\_\_ Quote Due \_\_\_\_\_ Desired Delivery \_\_\_\_\_  
 Phone No. \_\_\_\_\_ Contact Email \_\_\_\_\_ State \_\_\_\_\_  
 Sales Contact \_\_\_\_\_ Quote #: \_\_\_\_\_  
 Quantity \_\_\_\_\_

### Product Specs:

**Max:**  
 - Width (inches): \_\_\_\_\_ Length (inches): \_\_\_\_\_  
 - Height (inches): \_\_\_\_\_ Weight (lbs): \_\_\_\_\_  
**Min:**  
 - Width (inches): \_\_\_\_\_ Length (inches): \_\_\_\_\_  
 - Height (inches): \_\_\_\_\_ Weight (lbs): \_\_\_\_\_  
 Description: \_\_\_\_\_  
 Max. Qty.: \_\_\_\_\_ Total Live Load: \_\_\_\_\_  
 Capacity Limitations (must meet all three)  
 15 lbs/roller, 50 lbs/ft, 100 lbs/zone

### Roller Specs:

- 1.4 dia x 18 ga
- 1.9 dia x 16 ga

### Application Type:

- Transportation
- Accumulation

### Conveyor Construction:

- Between Frame (BF):  18"  24"  30"
- Expanded Roller Centers:  3"  4"  5"
- Minimum Package Size:  9"  12"  15"
- Expanded Length:  25'  40'  50'  60'

### Options:

- 6" Casters  8" Casters
- Flexible Guide Rails  Interface Kit
- Reversing Stop  Stopping Photo-eye

### Height:

- 30" TOR + -4" adjustment
- \_\_\_\_\_

### Plant Voltage:

- 110V Single

### Speed:

- Fixed \_\_\_\_\_ FPM
- Variable \_\_\_\_\_ to \_\_\_\_\_ FPM

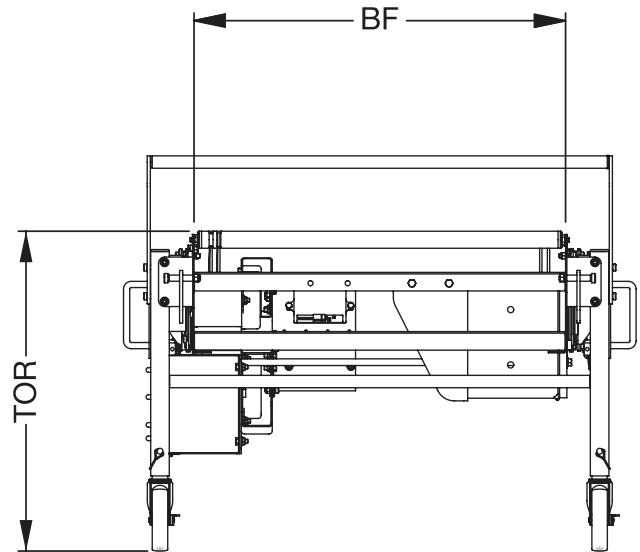

**Notes:** \_\_\_\_\_  
 \_\_\_\_\_  
 \_\_\_\_\_  
 \_\_\_\_\_

Approval Drawing Required:  Yes  No